

# BlackBerry 10.2.1

BlackBerry 10 OS, version 10.2.1 continues to build on the BlackBerry 10 platform for the Z10, Q10 and Z30 devices.

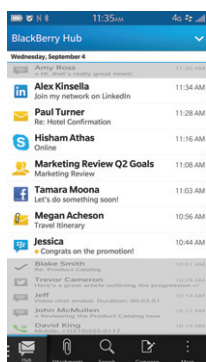

## PINCH TO PRIORITIZE

- Don't miss important messages
- Pinch the Hub to view Priority Hub items
- Customize pinch gesture for Unread or Flagged messages

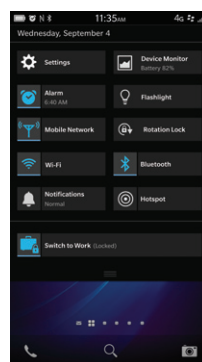

## CUSTOMIZED QUICK SETTINGS

- Customize options and toggles to suit your specific needs
- Offers an easy-to-find switch between personal/work perimeter
- Available Quick Setting Options Include:
  - Show or hide shortcuts for Location, Tethering, Hotspot, NFC and Flight Mode, Flashlight, Device Monitor and much more
  - Quick Settings allow you toggle the feature on and off or jump straight to the setting page for the desired feature

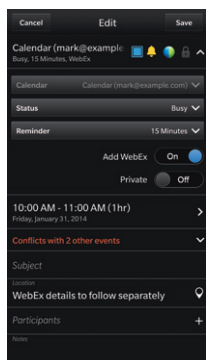

## IMPROVED CALENDAR UI

- Be more efficient with WebEx Integration, go-to-date quick access and category synchronization

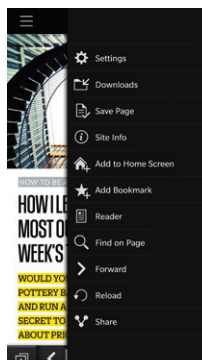

## OFFLINE READING MODE

- Save current page, for later viewing, to save the current page you will need network to open it
- Use the "Save Page" option to create an offline copy

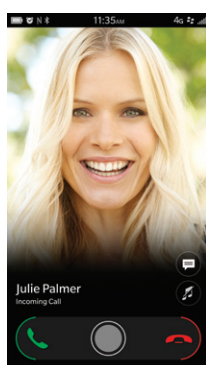

## SIMPLIFIED PHONE UI

- A refreshed UI makes answering/declining the incoming call simpler
- A new dedicated "Reply Now" icon appears when your phone rings so you can send a quick response via BBM, SMS or E-Mail to incoming call when you are too busy to pick up
- Call your contact back directly from the BlackBerry Hub
- Dial by Name for Q10, physical keyboard users will have the ability to initiate phone calls by dialing the name of the intended party on the Dial Pad

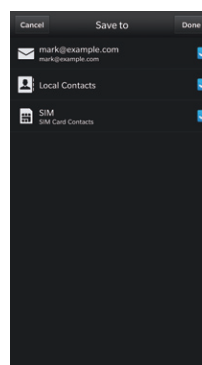

## PREFERRED CONTACT SYNC

- You can now choose the sync source for your contacts, ensuring you always have the most up-to-date contact details
- Sources include Corporate address book, Gmail, Hotmail, etc

# BLACKBERRY CHANGES

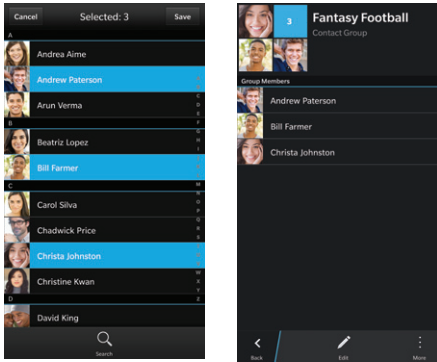

## SMS & EMAIL GROUPS

- Create groups for fast, efficient communication

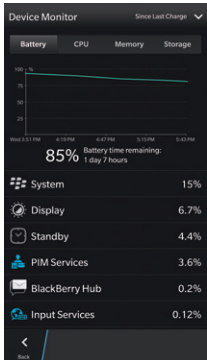

## DEVICE MONITOR

- Details on battery usage, impact of apps on battery life and memory use
- Stats about CPU, mobile network and Wi-Fi connections

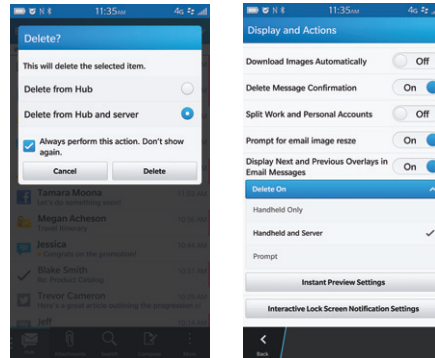

## “DELETE PRIOR” AND “DELETE ON”

- Specify from where a message is deleted
- Delete options now include: Handheld Only, Mailbox & Handheld and Prompt

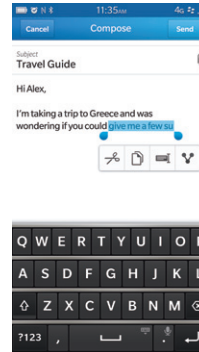

## COPY & PASTE IMPROVEMENTS

- Shortcut menu with icons to help copy, paste, select all, etc

## ANDROID RUNTIME

- New Android Native Support adds support for running native versions of Android JellyBean applications in APK format without the need to convert
- Applications using Android Bluetooth® SPI's are now supported
- Android application can integrate with BlackBerry Share Targets

## APK INSTALLATION

- Install APK files directly from the browser, email or File Manager
- Tap APK file to install, and the wizard will walk you through installation

## LEVEL 1 NOTIFICATIONS

- Ability to set level 1 notification using account filters within Hub
- Level 1 notification can override currently selected notification profile
- Contact Notification allows customizing options for phone, SMS, e-mail on a per-contact basis

## ACTION BARS

- Minimize the number of steps needed to complete tasks with action bar shortcuts

## BLACKBERRY CHANGES

---

### ACTIONABLE LOCK SCREEN NOTIFICATIONS

- Initiate software updates regardless of how they are connected to the internet
- Allow for automatic updates over Wi-Fi

### SOFTWARE UPDATES

- Initiate software updates, even if you're not connected to the Internet

### ENTERPRISE FEATURE SUMMARY

#### Productivity

- Stay on top of important messages
- Customize notifications on a per-contact basis
  - Set notifications to Level 1 (override current profile)
- Floating Action Bars reduce number of steps needed to complete tasks
- Improved Calendar UI, WebEx integration, go-to-date quick access and Microsoft calendar categories synchronization help you get more done

#### Security

- Offers Industry Leading Advanced Data at Rest Protection (ADARP)
- Multiple security domains within the Work Space
- Data in Work Space can be locked in File System
- 2nd factor authentication ties key encryption outside ADARP information

#### Communication

- Offers more ways to make and take calls
- Choose the sync source for contacts for the most current details
- Sources include Gmail, Hotmail and Corporate Address Book
- New screens for incoming call and speed dial from Home
- Offers dial-by-name and SMS from call log
- Improved handling of multiple phone lines for wireless and VoIP
- Create groups for fast, efficient communication

### BLACKBERRY ENTERPRISE SERVICE 10

- Offers more control with additional policies for better safeguarding
- Additional IT policies for granular control, email domain whitelist and blacklist support
- Lock screen behavior for IT policies
- Option to set corporate lock screen message
- Improved browser password authentication for intranet sites access
- Box and Dropbox clients must now be approved for deployment from BES
- Improvements to BlackBerry Balance include:
  - Access to personal content
  - Includes Camera pictures for file uploads to internet sites
  - Easier access to Work Browser
- SMS & PIN Logging with SMS Intercept
  - SMS & PIN Logging allows IT administrators to log all SMS and PIN messages using the BlackBerry Enterprise Service 10 IT Policies
  - SMS Intercept allows IT administrators to append a corporate disclaimer to all SMS messages sent from a BlackBerry connected to the BES. The feature is controlled using IT Policies
- Certificate Management & Wireless Synchronization
  - Administrators can configure BlackBerry Enterprise Service 10 to enable wireless synchronization of S/MIME and VPN certificates

### EXCHANGE ACTIVESYNC

- ActiveSync 14.1 is now supported

# BLACKBERRY CHANGES

Also new to the BlackBerry Z10 and Q10 are features of BlackBerry 10 OS Version 10.2 already available to the Z30.

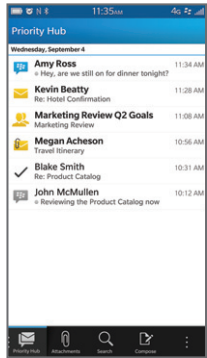

## PRIORITY HUB

- Access the most relevant, time-sensitive information first and respond faster to avoid missing opportunities
- Priority Hub learns what conversations and people are most important, and prioritizes messages accordingly



## ATTACHMENT VIEW

- Takes the hassle out of finding and viewing attachments
- Switch to attachment view to see attachments across all your messages, or filter by conversation and account
- Find files, documents and photographs quickly without finding the exact message



## BBM NATURAL SOUND W/SCREEN SHARE

- Delivers a more natural and realistic sound for BBM™ Video and Voice Conversation between smartphones running BlackBerry 10
- Ideal for quick communication and decision making with colleagues
- Hear the tone in voices for better understanding and more confident communication
- Bring others in to live experiences like meetings and events with BBM Video and share what's on your screen



## BBM NOW

- Chat on BBM while browsing the web, watching a video or working on a document
- Talk with friends regardless of what phone they use with BBM for iOS and Android
- Respond quickly to important messages, or provide a quick answer without stopping what you're doing

## BLACKBERRY CHANGES

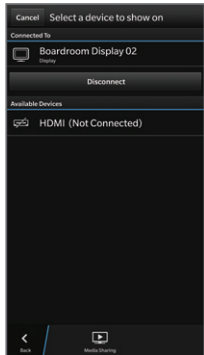

### MIRACAST

Available on Q10, Z30

- Turn a great presentation into a big presentation
- Show presentations on a monitor or large screen through a micro HDMI cable or stream wirelessly with Miracast
- Show an exact copy of device display on a TV or monitor with Mirror Mode
- Supports Wi-Fi alliance standards for streaming video and audio between two compliant devices
- Play-On mode lets you stream onto a TV or monitor while using your device for other things



### AUTOMOTIVE INTEGRATION

- Voice Control
  - Keep working, even while traveling, with the following voice controls:
    - Enhanced voice control in all Bluetooth-enabled vehicles
    - Read, compose and send BBM messages using audible and voice recognition features
    - Designed for no-look and hands-free operation, helping keep you safely connected and responsive
- Vehicle-specific apps
  - Get apps specific to your car
  - Dedicated channel in BlackBerry World for apps and content from your auto maker
  - Find a dealership and schedule car services
  - Integrate BlackBerry maps integration
- Intelligent Automotive Detection
  - Recognizes the make of the vehicle when connected

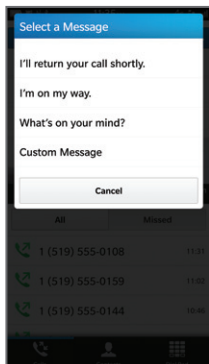

### BLACKBERRY PHONE: REPLY NOW

- Let callers know you're tied up by using Reply Now to send a quick message back when you can't chat
- Offers a quick and polite response when you don't have time to take a call

## BLACKBERRY CHANGES



### LOCK SCREEN MESSAGE PREVIEW

- Lock Screen becomes interactive and provides real-time information as it arrives
- Each notification icon becomes a touch point allowing the user to check any notification type, whether it's email, BBM or text messages
- Swipe right and left on the Notifications section to change between Message Preview and standard lock screen view
- Customize notifications based on accounts and message priority

### VOICE CONTROL & ACCESSIBILITY FEATURES

- BlackBerry Voice Control
  - Read your last message, search your phone or find information online
  - Developers can use voice control to introduce new experiences to their applications
- Screen Reader
  - Aids in accessibility for those with visual impairments and is available in BlackBerry World
- Closed Captions / Subtitles
  - Closed Caption support has been added for those with hearing impairments.
  - Available in the Web Browser and Media Player

### BLACKBERRY CALENDAR "I WILL BE LATE"

- Inform meeting participants that you're running late with the new "I will be late" option in BlackBerry Calendar

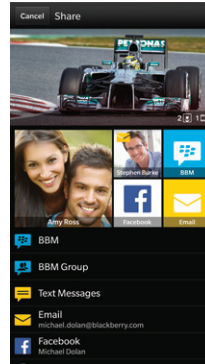

### ADAPTIVE SHARING & NEW SHARE TARGETS

- Learns your sharing habits, including who you share with and how you share
- Frequent sharing destinations are suggested visually
- New Share Targets
  - Share to Meeting Participants
  - Share via QR Code
  - Share via Wi-Fi Direct

### USB HOST MODE

Available on Z30

- Connect USB devices enabling external storage or mouse and keyboard peripherals
  - USB thumb drives will appear as mounted drives in File Manager
- Supports USB Micro B OTG adaptors for connectivity to USB peripherals

### WI-FI DIRECT

Available on Q10, Z30

- Allows direct Peer-to-Peer connections without the need for wireless access points
- Offered as a method to share with other devices, similar to Bluetooth
- NFC Sharing will use Wi-Fi direct (when available) instead of Bluetooth for faster transfer speeds